

Mini Remote(2.4GHz)

Model No.: K2 / K2-B / K2S / K2S-B

Contents

<u>Product Features</u>	2
<u>Product parameters</u>	2
<u>Button Description</u>	3
<u>Install battery</u>	3
<u>Instructions for pairing/clearing codes with lamps</u>	4
<u>Installation Notes</u>	5
<u>Attention</u>	6

1. Product Features

Mini remote adopts 2.4GHz frequency with low power consumption long distance transmitting, strong anti-interference, and fast communication rate, Simply press the button on the remote control, You can enjoy the comfortable lighting effect. Mini easy for using, Magnetic installation is very firm. Can control designated Mi-Light / MiBoxer 2.4G lamps, The color temperature and brightness of the light can be adjusted. Now start, let the light do whatever you want.

2. Product parameters

Model No.: K2 / K2-B / K2S / K2S-B
Working Voltage: 3V (CR2032 battery)
Transmitting Power: 6dBm
Standby Power Consumption: <math><6\mu\text{A}</math>

RF: 2.4GHz
Working Temperature: -10~40°C
Control Distance: 30m

K2 / K2-B

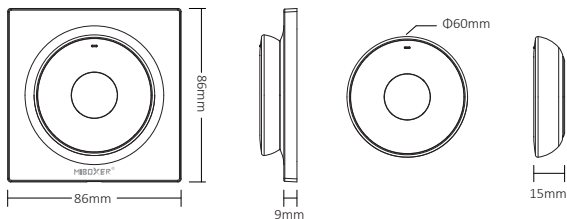

K2S / K2S-B

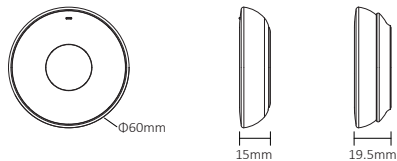

3. Button Description

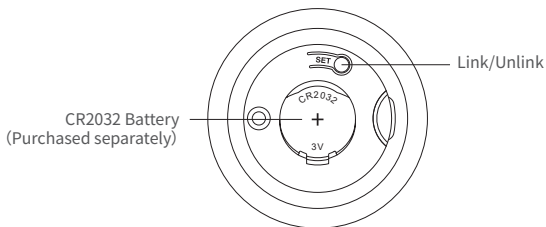
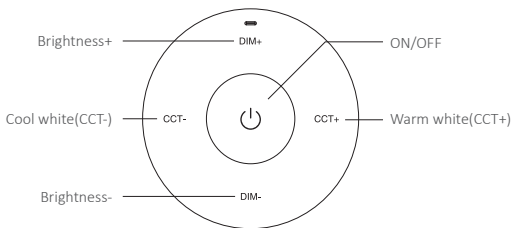

4. Install battery

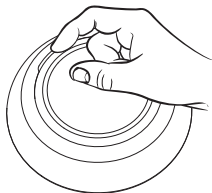

1. Open battery cover

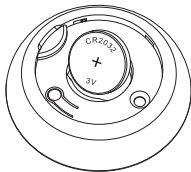

2. Install the battery as photo
(CR2032 Purchased separately)

5. Linking/Unlinking

Note: Remote need link with lights before control light.

Linking instruction

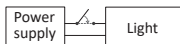

- 1 Turn off light after 10 seconds turn off



- 2 Short press "SET" 3 times within 3 second when the light on



- 3 Light flashing 3 times slowly means it is successfully



Linking failed if light is not blinking slowly, Please follow above steps again.

(Note: Light that have linked can't link again)

Unlinking instruction



- 1 Turn off light after 10 seconds turn on

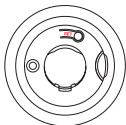

- 2 Short press "SET" 5 times within 3 second when the light on

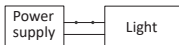

- 3 Light flashing 10 times slowly means it is successfully



Unlinking failed if light is not blinking quickly, Please follow above steps again.

(Note: Light haven't linked that don't need to unlink)

6. Installation Notes

K2 / K2-B:

Method 1

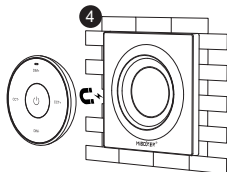
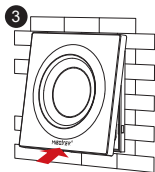
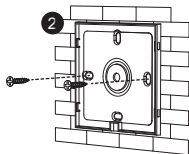
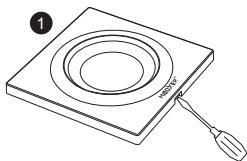

Method 2

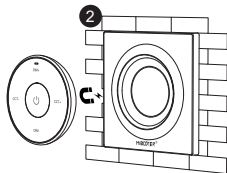
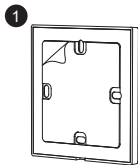

Take off the double-sided tape on the back of the base

Stick the base well, and the remote control is magnetically attracted to the base

K2S / K2S-B:

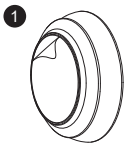

Take off the double-sided tape on the back of the base

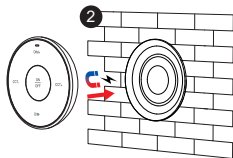

Stick the base well, and the remote control is magnetically attracted to the base

7. Attention

1. This remote only control specified Mi-Light / Miboxer products; details please check manual.
2. This remote control is a precision electronic product, please do not use it in a humid or high temperature environment for a long time. When not in use for a long time, please take out the battery and store it in a dry, static-free environment.
3. Do not use the remote control in a large area of metal or in an environment with strong electromagnetic waves nearby, otherwise the control distance will be seriously affected.



Made in China