



Features

This 8-zone smart panel remote is made of elegant stalinite panel and high-precision touching IC; touching is more stable and sensitive. And adopt world-wide used 2.4GHz frequency, GFSK control method, with the features of low power consumption, long distance transmitting, strong anti-interference and fast communication rate; can control specified Mi-Light smart light with color, color temperature, saturation and brightness changing. Working on all our MiBoxer LED lamps, controller and panel controllers, etc.

Parameters

Model No.: B8
 Working Voltage: 3V(2*AAA Battery) / DC3.3V
 Transmitting Power: 6dBm
 Standby Power: 30uA

Transmission Frequency: 2.4GHz
 Modulation Method: GFSK
 Control Distance: 30m
 Working Temp.: -20~60
 Size: 106*146*20mm

Panel Remote Controller Name	Compatible Remote Model	Compatible Products
8-Zone Smart Panel Remote Controller	FUT089	RGB+CCT series LED Bulb series LED Floodlight series 5 in 1 Smart LED Controller

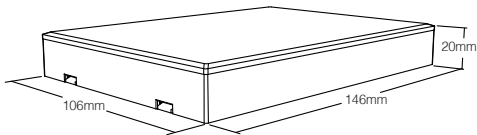

8-Zone Smart Panel Remote Controller
 Model No.: B8

Function of keys

Remark:

When touching the button, LED indicating lamp will flash once with different sound (Touch slider with no sound).

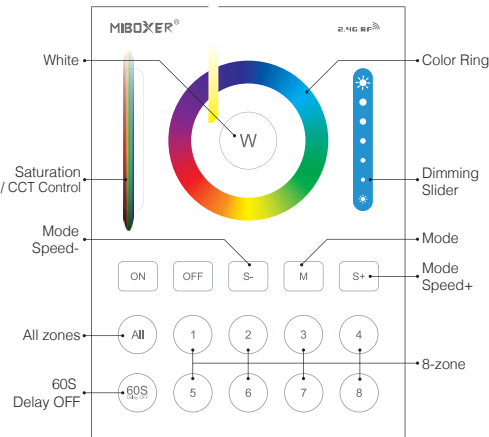

- Touch the color ring to change colors.
- Under white light mode, adjust color temperature; Under color light mode, change color saturation.
- Slide the brightness slider to adjust the brightness.
- Press the button to get white light.
- Turn on the linked lights. Long press "ON" button for 10 seconds to set up the button sound.
- Turn off the linked lights. Long press "OFF" button for 10 seconds to close the button sound.
- Press the button, to open the "60S delay" Function, the indicating lamp will shine; Press again cancel the "60S delay" Function, the indicating lamp will be off.
- Dynamic mode switching button.
- Lower the dynamic mode speed.
- Accelerate the dynamic mode speed.
- Press "ALL" button, to control all linked lights, and the indicating lamp shine meanwhile.
- Press 1-8 zone, to control the corresponding zone linked lights, and indicating lamp will shine.

Installation/ Dismantlement

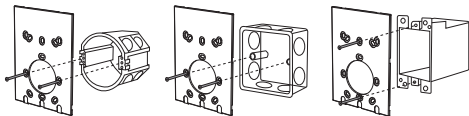

Input 1:
3V(2*AAA Battery)

Input 2:
AC90~120V
or AC180~240V

MiBoxer specified power supply
need to be purchased separately.

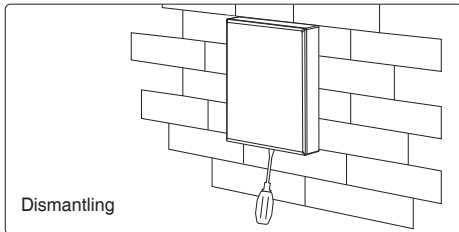
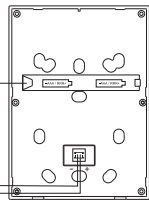

Dismantling

Attention

1. Please check the cable, and make the circuit is correct before power on.
2. When installation, pls handle with care to avoid the broken of the glass panel.

Installation

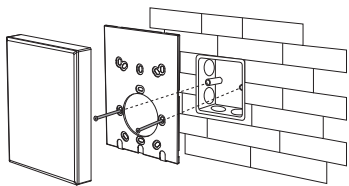

Made in China

Linking Instructions



- 1 Click the 1-8 zones button you want to link, the corresponding indicating lamp will shine.

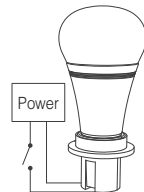

- 2 Switch off the light, after 10 seconds switch on again

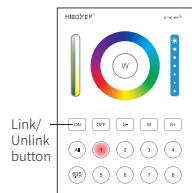

- 3 When the light on, short press "Link/Unlink" button 3 times within 3 seconds

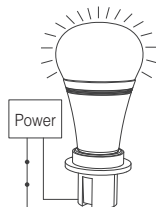

- 4 The light blink 3 times slowly means the linking is done successfully.



If the light not blink slowly, the linking failed, Pls switch off the light again, and follow the above steps again.

Unlinking Instructions



- 1 Click the 1-8 zones button you want to unlink, the corresponding indicating lamp will shine.

Unlinking must be the same zone with the Linking

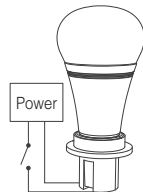

- 2 Switch off the light, after 10 seconds switch on again.

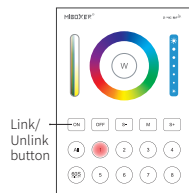

- 3 When the light on, short press "Link/Unlink" button 5 times within 3 seconds

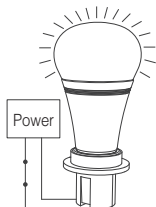

- 4 The light blinking 10 times quickly, means the unlinking successfully.



If the light not blink quickly, the unlink failed, pls switch off the light again, and follow the above steps to unlink again.